

Weather Resistant Disabled Refuge Outstation

Features

- ▶ Weather resistant enclosure
- ▶ Disabled Refuge outstation 'Type B'
- ▶ Single button 'hands-free' user operation
- ▶ Call registered and power on status indicators
- ▶ Straightforward 2 wire installation
- ▶ Toilet alarm input connections
- ▶ Induction loop included
- ▶ Output to mute local sounders/speakers
- ▶ Stainless steel or photo luminescent green fascias
- ▶ Etched text front stainless steel panel fascia
- ▶ Compatible with Safe-Point loop connectivity panels only



Description

The K41400SST is a weather resistant 'Type B' call/answer point, fully compatible with Kentec's Safe-Point range of products.

Fitted at Disable Refuge locations, at the touch of a button, the unit provides the means to effectively voice communicate with building control operatives. LED status indicators provide a visual sign that a call is registered and that power to the unit is healthy. An integrated induction loop provides assistance to hearing aid users.

Typical Installation Scenario

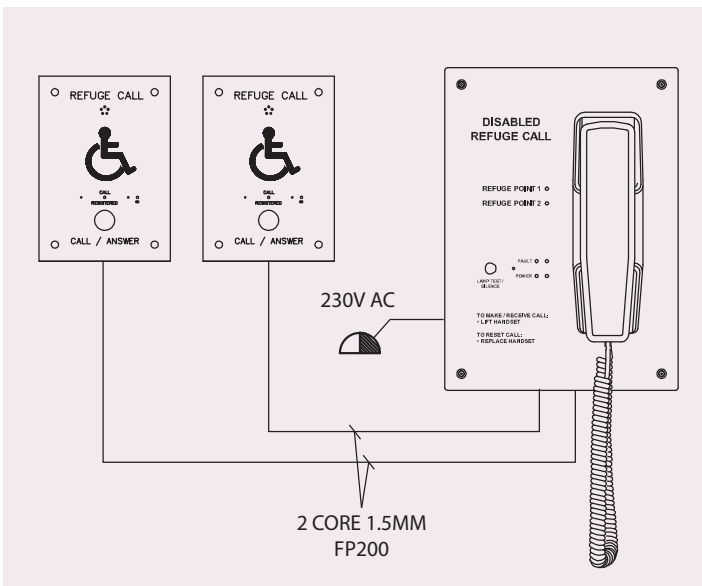

Unit			
Product Code	Enclosure Type	Enclosure Material /finish	Connectivity
K41400SST	Surface	ABS-Steel/EPC black	Loop

Specifications	
Dimensions (mm)	Enclosure: 190 (W) x 265 (H) x 65 (D)
Weight	2Kg